



INSTALLATION INSTRUCTIONS

Not legal for sale or use in California on any pollution controlled motor vehicle.

50-2544 DODGER / CHRYSLER 2011-23 CHARGER 2011-23 CHALLENGER 2011-23 300 V6-3.6L

- TOOLS NEEDED:**
- Ratchet
 - Extension
 - 8mm Socket
 - 10mm Socket
 - 14mm Socket
 - 5/16" Nut Driver
 - Adjustable Wrench

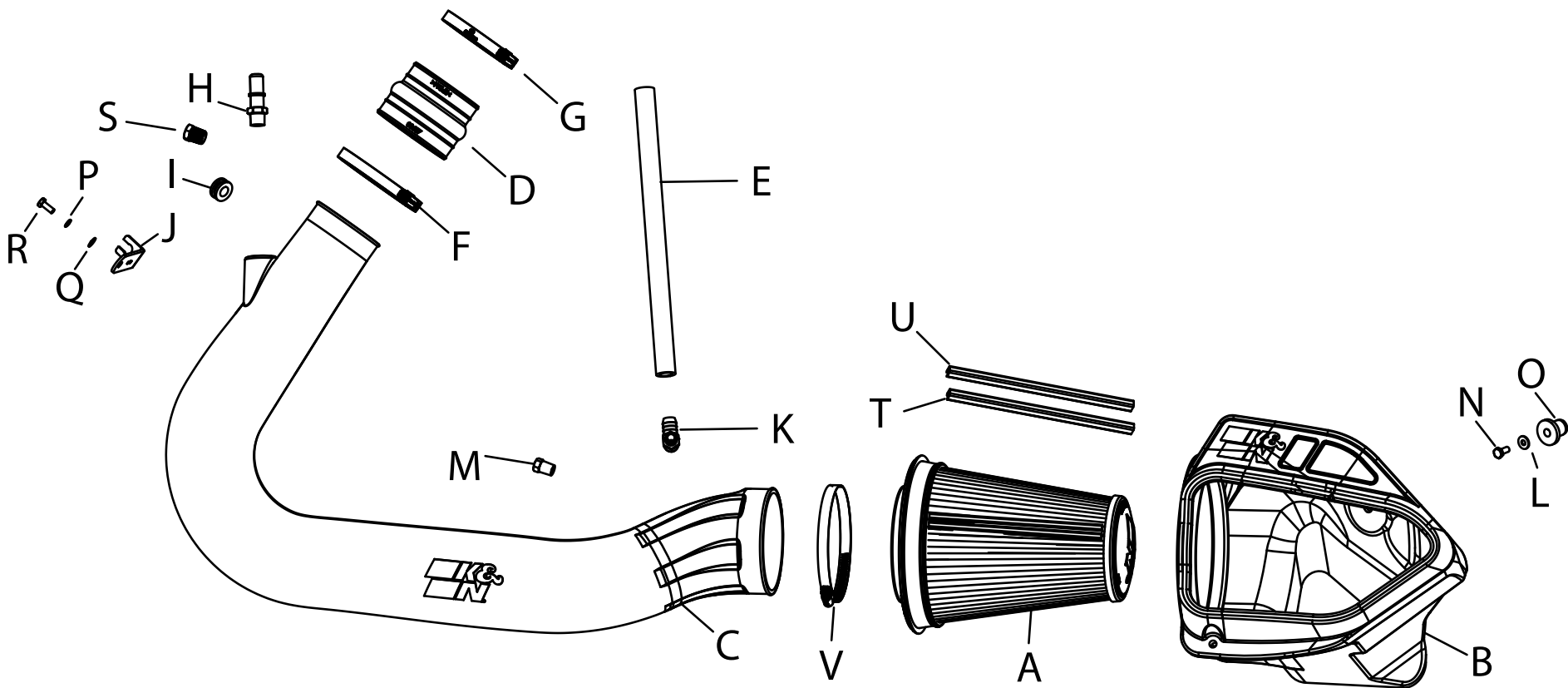

PARTS LIST:

Description	Qty.	Part #	Description	Qty.	Part #	Description	Qty.	Part #
A AIR FILTER	1	RU-5302	H FITTING; QUICK CONNECT	1	82637-1	O INSERT; 3/8-16 RUBBER	1	08163
B AIRBOX	1	087620	I GROMMET; 1/2"ID	1	KITGRMT03	P WASHER; M6, SPLIT LOCK	1	1-3025
C TUBE	1	087631	J BRACKET; "L"	1	083154A	Q WASHER; 6MM FLAT	1	08269
D HOSE; HUMP 3.25"ID- 3.5"ID	1	08657	K FITTING; VENT, ALUM, 1/4"NPT	1	08525-1	R BOLT; M6-1 X 16MM	1	07812
E HOSE; 5/8"ID X 14"L	1	084083	L WASHER; 8MM, FLAT	1	08272	S PLUG; 3/8 NPT, PLASTIC	1	08350
F HOSE CLAMP; #56 BLK	1	08620KA	M PLUG; 1/4 NPT, PLASTIC	1	08032	T CLIP; SNAP-ON, RED	1	088218
G HOSE CLAMP; #52 BLK	1	08610KA	N BOLT; 3/8"-16 X 1-1/4"L	1	07779	U CLIP; SNAP-ON, ORANGE	1	088219
						V HOSE CLAMP; #88 BLK	1	KITHS88K

If you need any assistance please call 1-800-858-3333 to speak with a representative in our Customer Service Center before returning the product.

NOTE: FAILURE TO FOLLOW INSTALLATION INSTRUCTIONS AND NOT USING THE PROVIDED HARDWARE MAY DAMAGE THE INTAKE TUBE, THROTTLE BODY AND ENGINE.

TO START:

1. Turn off the ignition and disconnect the negative battery cable.
NOTE: Disconnecting the negative battery cable erases pre-programmed electronic memories. Write down all memory settings before disconnecting the negative battery cable. Some radios will require an anti-theft code to be entered after the battery is reconnected. The anti-theft code is typically supplied with your owner's manual. In the event your vehicles anti-theft code cannot be recovered, contact an authorized dealership to obtain your vehicles anti-theft code.



2. Lift the engine cover and remove it from the vehicle.



3. Disconnect the IAT sensor electrical connection.



4. Disconnect the CCV hose from the air filter housing. NOTE: On later models the CCV line connection will be near the throttle body.



5. Loosen the hose clamp that secures the intake tube to the throttle body.



6. Remove the bolt that secures the air filter housing to the core support.



7. Remove the complete stock intake system from the vehicle.



8. Install the provided insert nut onto the K&N filter housing using the provided hardware. This will seat into the inside fender hole of vehicle.

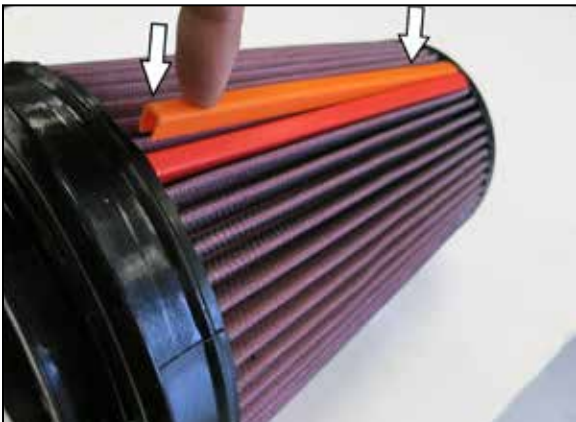

9. Attach the filter clips to the pleats on the air filter align and push down. Driver side filters, place orange clip on top and red on bottom.



10. Partially place air filter into air box and Install the K&N air filter housing into the vehicle. **NOTE: Before Install of the filter, tighten insert nut using 14mm socket.** Now push K&N air filter into the K&N air filter housing. Secure with the factory mounting bolt.



11. Install the provided quick connect fitting and npt plug into the K&N intake tube. 2011-19 models will use the 90-degree fitting near the filter end of the tube. 2020-23 models will use the straight fitting near the throttle body end of the tube



12. Install the provided CCV hose onto the 90-dgree CCV fitting for the early models.



13. Install the provided hump coupler onto the throttle body and secure with the provided hose clamp.



14. Remove the IAT sensor from the factory intake system, remove the O-ring from the sensor and then install it into the K&N intake tube using the provided grommet.



15. Install the K&N intake tube into the air filter and then into the coupler at the throttle body. Do not secure the hose clamps yet.



16. Remove the mounting grommet from the factory intake tube and install it into the provided mounting bracket.

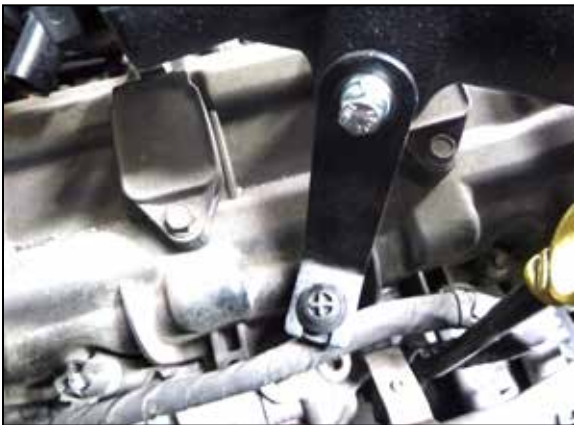

17. Install the mounting bracket onto the intake tube with the provided hardware and then onto the mounting post on the engine. Adjust the assembly for best fit and then secure the hose clamps.



18. Reconnect the IAT sensor electrical connection.



19. On 2011-19 model vehicles, connect the CCV hose to the factory CCV tube. On 2020-23 models connect the factory CCV hose to the fitting installed into the K&N intake tube.



20. Reconnect the vehicle's negative battery cable. Double check to make sure everything is tight and properly positioned before starting the vehicle.

21. It will be necessary for all K&N® high flow intake systems to be checked periodically for realignment, clearance and tightening of all connections. Failure to follow the above instructions or proper maintenance may void warranty.

ROAD TESTING:

1. Start the engine with the transmission in neutral or park, and the parking brake engaged. Listen for air leaks or odd noises. For air leaks secure hoses and connections. For odd noises, find cause and repair before proceeding. This kit will function identically to the factory system except for being louder and much more responsive.
2. Test drive the vehicle. Listen for odd noises or rattles and fix as necessary.
3. If road test is fine, you can now enjoy the added power and performance from your kit.
4. K&N Engineering, Inc., requires cleaning the intake system's air filter element every 100,000 miles. When used in dusty or off-road environments, our filters will require cleaning more often. We recommend that you visually inspect your filter once every 25,000 miles to determine if the screen is still visible. When the screen is no longer visible some place on the filter element, it is time to clean it. To clean and re-oil, purchase our filter Recharger® service kit, part number 99-5050 or 99-5000 and follow the easy instructions.