

2011-22 SRT

6.4L V8

Part #: CC0013



IMPORTANT! WARRANTY AND INSTALLATION INSTRUCTIONS

Please Forward All Information to Consumer

Be sure to review the enclosed instructions prior to beginning the installation process. If you have any questions about the enclosed parts or instructions, or if you encounter a problem during installation:

CALL TECHNICAL SUPPORT: 440.891.0999 or 800.486.0999

**TO ACTIVATE YOUR WARRANTY GO TO:
CORSAPERFORMANCE.COM/WARRANTY**

COLOR INSTRUCTIONS ARE AVAILABLE BY PART NUMBER ON: CORSAPERFORMANCE.COM



**NEVER work on a hot engine bay.
Allow time for the vehicle to cool.**

INSTALL DIFFICULTY 

RECOMMENDED TOOLS & SUPPLIES

- 15mm Socket Wrench
- 11/16" Wrench
- 2.5mm Hex Wrench
-

Please take time to read and understand these installation instructions.

CORSA recommends that the installation of this system be performed by a qualified service center or professional installer who has the necessary equipment, tools, and experienced personnel. However, if you decide to perform this installation yourself, the use of an additional person may be required.

WARNING: Never work on a hot engine bay. Allow time for the vehicle to cool.

This warranty does not extend to damaged or defect in the finish of a product or to any product, that in the opinion of CORSA Performance, has been misused, damaged by accident or negligence, altered or modified in any way, faulty installation or installed contrary to CORSA installation instructions, or repaired by an unauthorized service facility.

Full warranty available on www.corsaperformance.com

Please confirm that all parts are present according to the bill of materials before beginning the installation.

If something is missing call Tech Support at 440.891.0999 or Toll Free: 1.800.486.0999

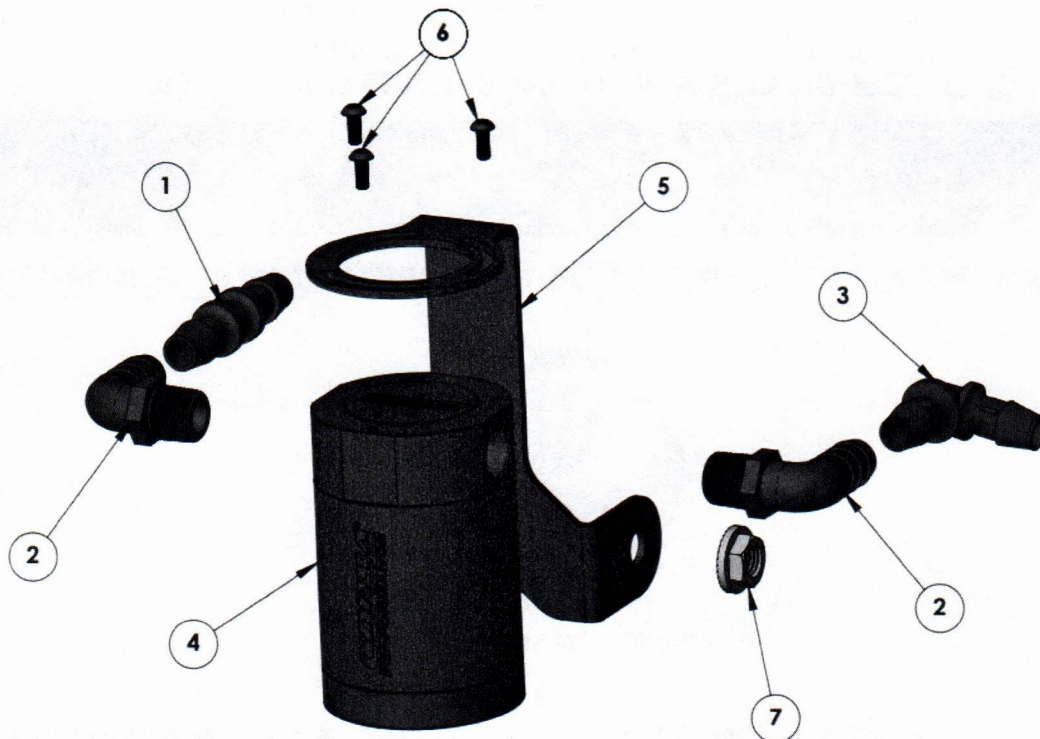

HARDWARE KIT

1. Barbed Straight Fitting	1	4. Catch Can Body	1	7. M10 Flange Nut	1
2. 3/8" NPT Barbed Elbow Fitting	2	5. Bracket	1	NOT PICTURED:	
3. Barbed Elbow Fitting	1	6. 4mm Hex Screws	3	8. 1/2" Hose A	11"
				9. 1/2" Hose B	4"

REMOVAL INSTRUCTIONS

FACTORY PCV LINE

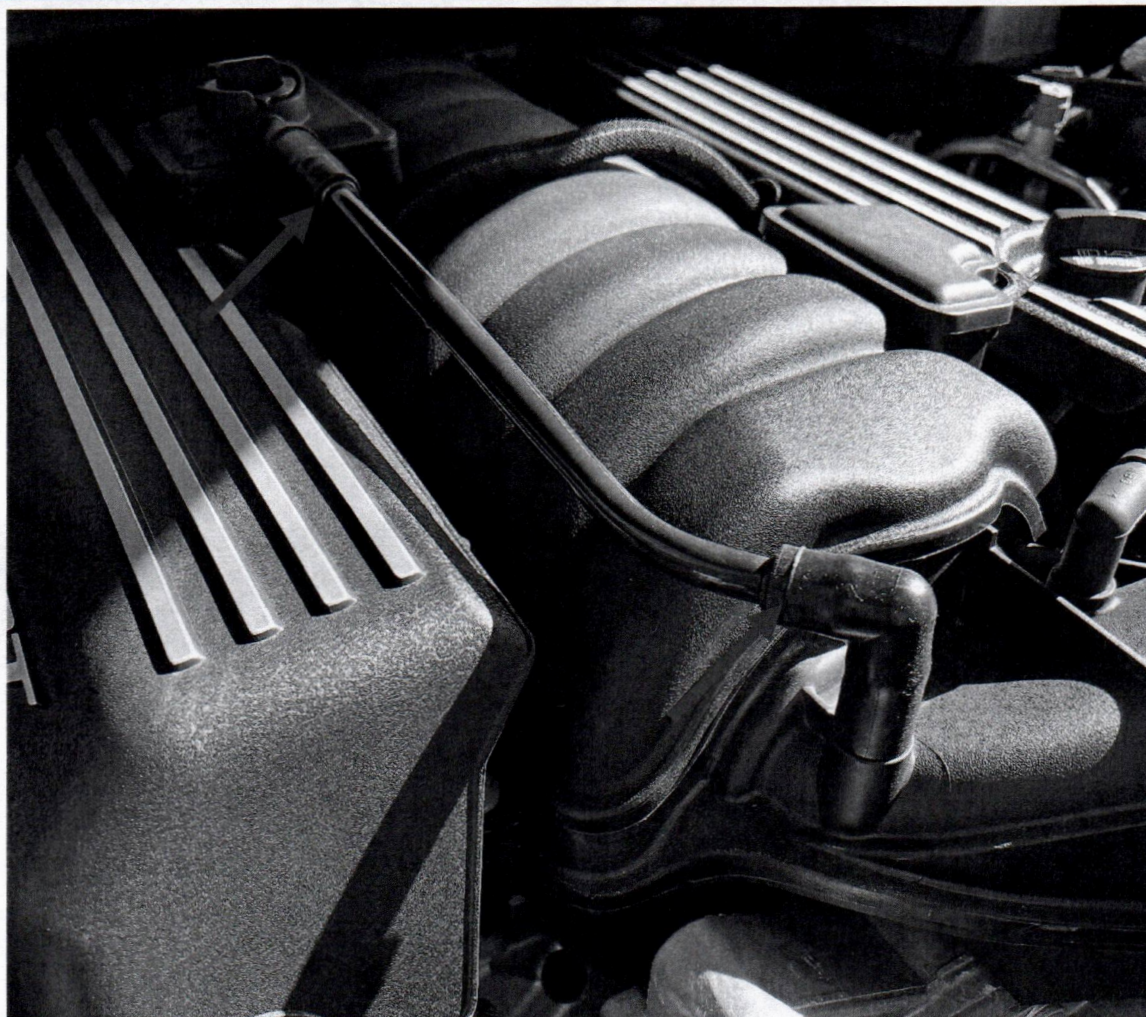

1. Locate the stock PCV line on top of the engine and remove it by pulling it off the rubber connections.

This concludes removal instructions.

INSTALLATION INSTRUCTIONS

CORSA CATCH CAN SYSTEM



1. Install barbed fittings and bracket to the catch can using an 11/16" wrench and 2.5mm Hex wrench.
IMPORTANT: Corsa recommends using thread sealant or PTFE tape on barbed fittings and bottom drain plug to prevent any leaks.

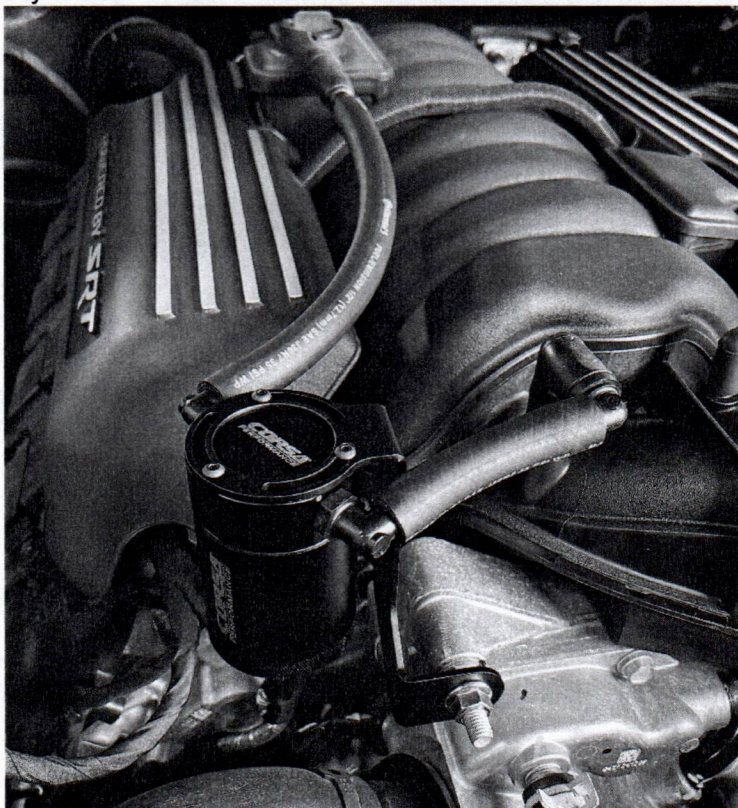

2. Use the provided nut and a 15mm socket wrench to secure the catch can bracket to the bolt extending off the front of the engine. Attach the 11" hose to the straight barbed fitting and route it to the A side of the catch can. Attach the 4" hose to the elbow barbed fitting and route it to the B side of the catch can.

This concludes installation instructions.

*Check that this catch can complies with your Federal, State and Local laws.
We recommend saving your stock PCV line.*

BEFORE ROAD TESTING

1. Start engine, leaving the transmission in park and securing the parking brake.
 2. Make sure to look and listen for any unusual noises or air leaks. Repair problems if needed.
 3. Once completed it will be necessary to check periodically, after a few heat cycles, for realignment and tightening of all connections.
-

EMPTYING CATCH CAN: Twist off the bottom of the catch can and dispose of collected oil. It is recommended to check and empty the catch can with every oil change.
