

P/N CH1103
INSTALLATION INSTRUCTIONS
08-10 Challenger 3.5L

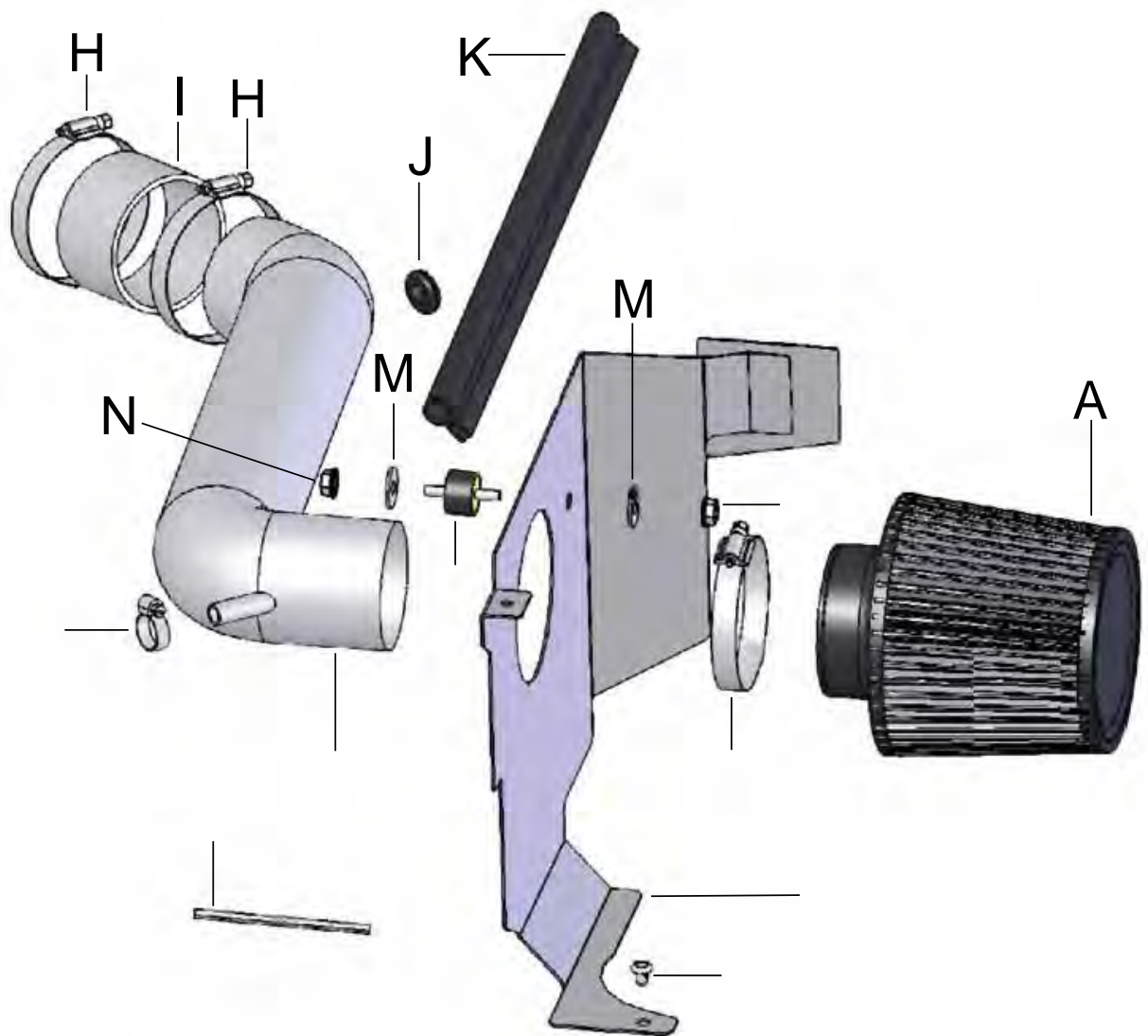

Read and understand these instructions **BEFORE** attempting to install this product. Failure to follow installation instructions and not using the provided hardware may damage the intake tube, throttle body and engine.

1. Preparing Vehicle

- a. Make sure vehicle is parked on level surface.
- b. Set parking brake.
- c. If engine has run in the past two hours, let it cool down.
- d. Disconnect the negative battery terminal.
- e. Do not discard stock components after removal of the factory system.

2. Removal of stock system



a. Disconnect the inlet air temperature (IAT) sensor connector.



b. Loosen hose clamp at the throttle body.



c. Remove the PCV breather tube from the air box.



d. Loosen and remove the air box mounting screw. This screw will be reused.



e. Remove the coolant line from the air tube.



f. Remove the air box assembly from the engine bay.

3. Installation of intake system.

- a. When installing the intake system, do not completely tighten the hose clamps or mounting hardware until instructed to do so.



b. Attach the rubber edge trim to the intake pipe opening on the heat shield.



c. Attach the foam gasket onto the top of the heat shield.



d. Insert the heat shield as shown. The vertical tab slides into the coolant reservoir. The bottom tab slides underneath the coolant and vacuum lines.



e. Insert the push-in clip on the heat shield base.

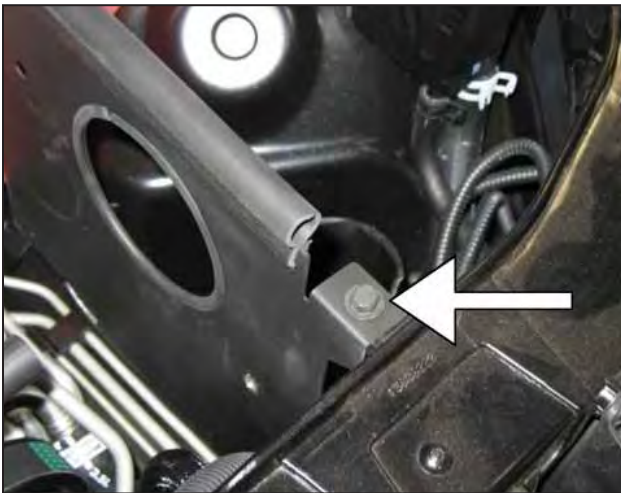

f. Secure the remaining tab with the factory screw.



g. Insert the rubber mount as shown.



h. Secure the rubber mount with the M8 washer and nut.



i. Insert the intake pipe as shown. Align the intake pipe bracket with the rubber mount.



j. Once the bracket is aligned, check the intake pipe for clearance around the rubber edge trim. Secure the bracket with a M8 washer and nut.



k. Reattach the PCV breather hose to the breather nipple on the intake pipe. Secure with a hose clamp.



l. Attach the air filter. Check for clearance around the rubber edge trim and secure.



m. Insert the grommet for the IAT sensor into the intake pipe. Insert the IAT sensor and reattach the IAT sensor harness connector that was disconnected in step 2a. Secure the intake pipe to the throttle body coupler.



intake system installed