

Installation Instructions JLT Series 3 Cold Air Intake Kit (2010 Mustang GT) #CAI3-FMG10

Thank you for purchasing our product. We hope you are satisfied with the look and performance.
Take your time and it will be a smooth install.

ATTENTION: A tune specific for this intake is required when installing this kit. Failure to add a tune specific for the JLT intake may result in major engine damage.

*****DO NOT INSTALL KIT AND DRIVE WITHOUT A TUNE! *****

Please review complete instructions prior to installing.

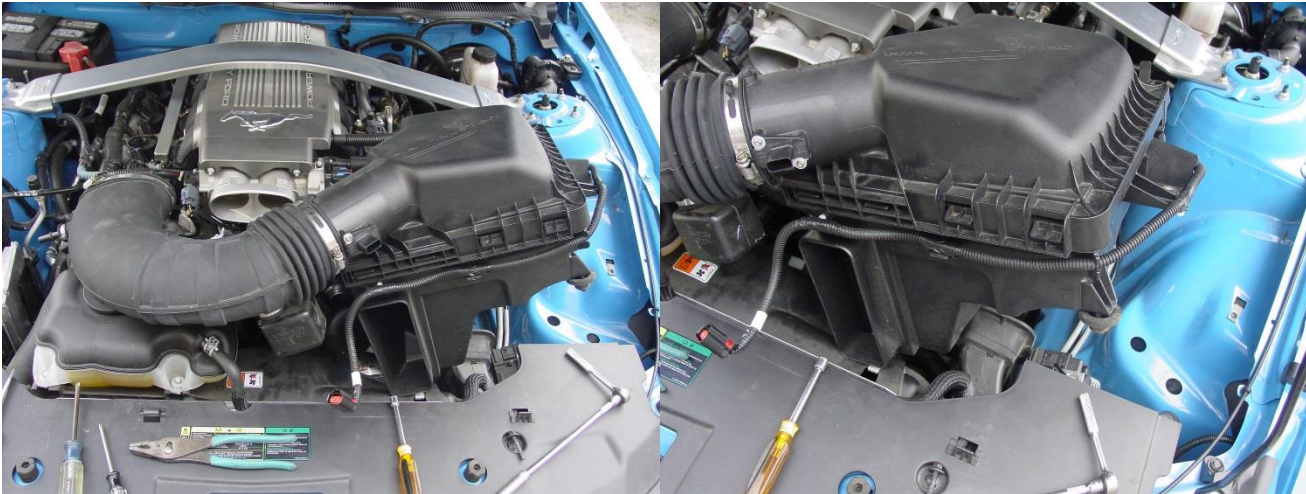
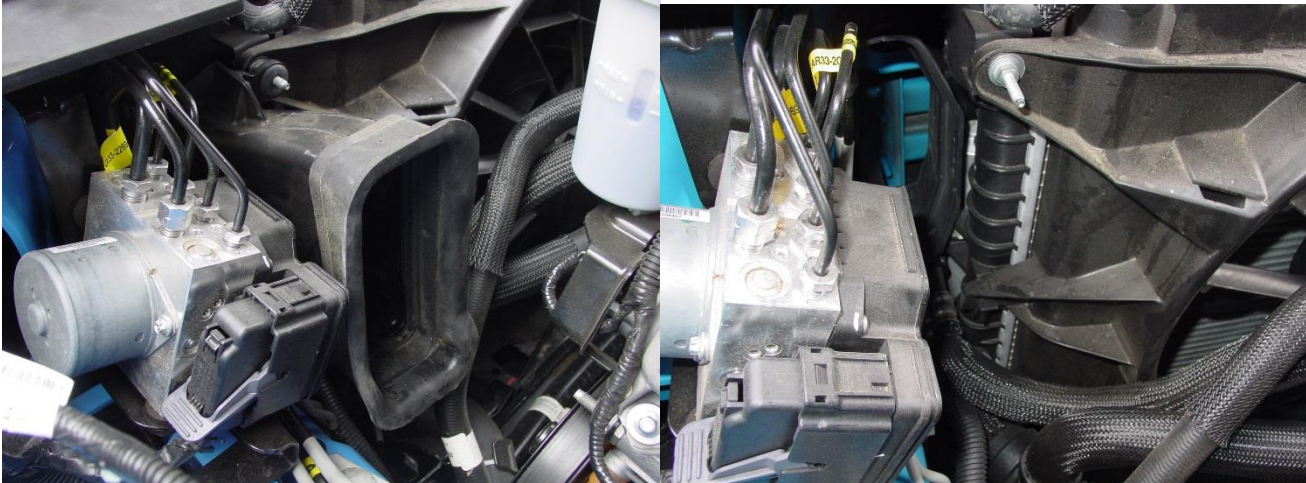
Step#	
1	<p>Verify you have all of the following parts included in the kit: (1) JLT plastic intake tube, (1) Silicone Coupler 4.5" ID x 2", (1) 4.5x9" Air Filter, (1) JLT Heat Shield, (1) PCV hose with fitting, (2) #72 Clamps, (2) MAF Screws, (1) MAF Gasket, (1) Firewall plug</p> <p>If package was purchased: SCT or Diablosport Tuner</p>
2	<p>Gather all of the following tools needed for the installation: 10mm socket, extension and ratchet, torx 20 driver, Phillips and flat head screwdriver</p>
3	<p>Install Tune for JLT Intake – Refer to instructions included with Tuner.</p>
4	<p>Remove the stock intake by loosening the clamp at the throttle body and removing the 10mm bolt holding down the airbox. Unhook the PCV line at the valve cover and lift up and out of front air inlet. Unhook MAF sensor wire harness from sensor and all around air box.</p> 
5	<p>Remove front air inlet coming from the grille. Use flat screwdriver to undo the 4 tabs (1 on each side). Once you get 2 or more give it a good tug straight out and it will pop off.</p> 

6

Remove the grommet from the stock air inlet removed in step 4 and insert it into the hole in the JLT heat shield. Slide heat shield on to the stud on the fan shroud and bolt down using stock air box bolt.



7

Unbolt the power steering reservoir and simply rotate the tank 180 degrees clockwise and install in the slot in the fan shroud and bolt back down using stock bolt.



- 8** Remove the MAF sensor from the stock airbox using a torx T-20 driver and install in the JLT MAF housing using supplied Phillips head screws and gasket. Screws just need to be snug.



- 9** Install coupler and clamps on to JLT tube and air filter on to JLT tube.
**** TIP ** Be sure to wipe any oil from the inside of air filter flange to avoid and slipping.**

- 10** Attach JLT intake kit on to throttle body and lightly snug hose clamps. **DO NOT OVERTIGHTEN CLAMPS!!**

- 11** The sound tube brings engine noise into the cabin. Adding the intake will increase engine sounds.
 Unbolt sound diaphragm behind shock tower and remove the entire unit. Then use supplied hole plug to cover hole in firewall from sound tube hose.

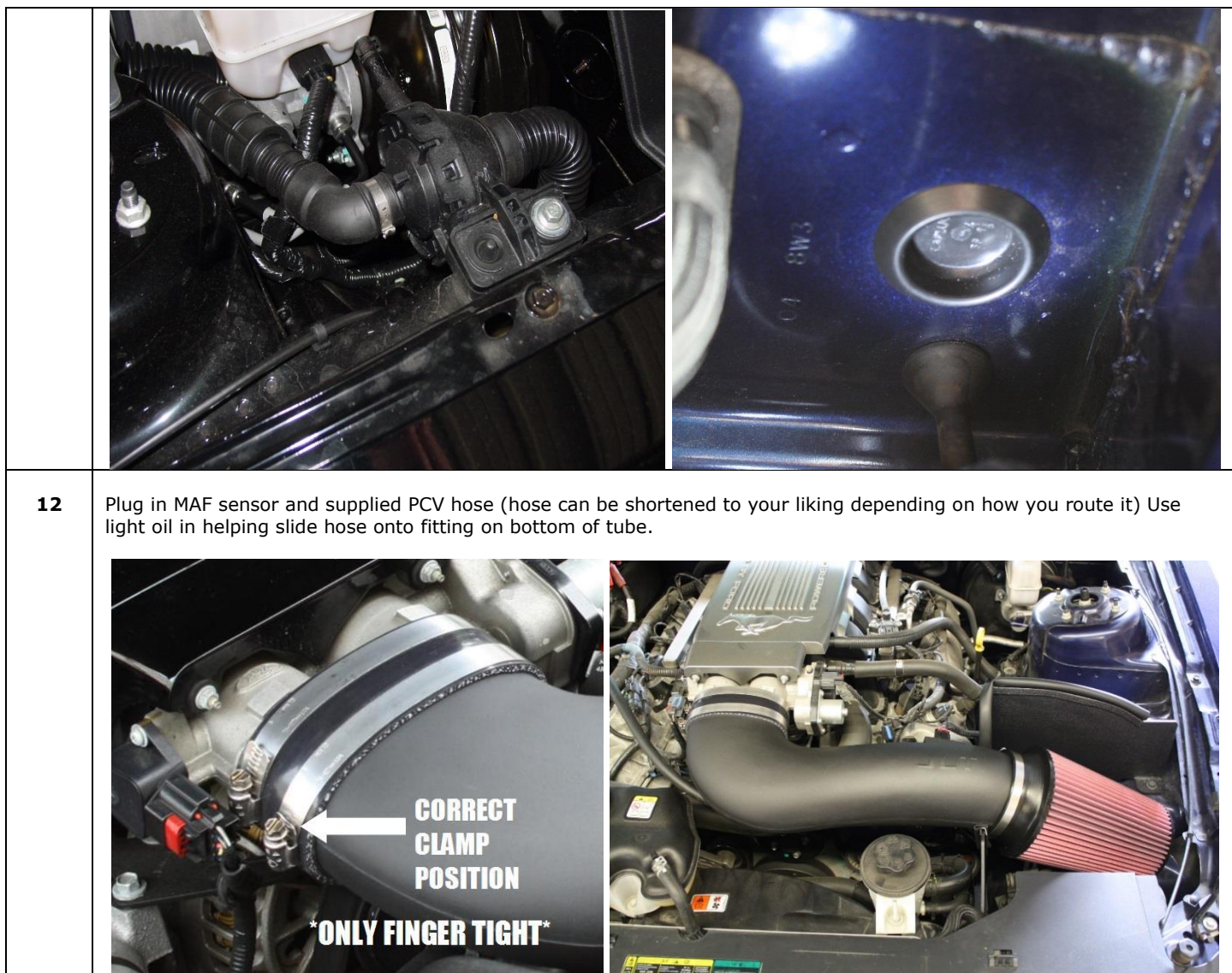

- 12** Plug in MAF sensor and supplied PCV hose (hose can be shortened to your liking depending on how you route it) Use light oil in helping slide hose onto fitting on bottom of tube.

Oil Filter: The frequency you should clean your filter will depend on your driving conditions. It is recommended to check your filter at every oil change or 3,000 miles. If there is a buildup of dirt as thick as the wire mesh, then it's time to clean your filter.

To properly clean your oil filter, we recommend the S&B Precision Cleaning & Oiling Kit (located in the Parts Sold Separately Section of our website, www.JLTtruecoldair.com).

Thanks for the business. If you have any questions, please e-mail info@JLTtruecoldair.com or call 757-335-1940. Our hours are Monday-Friday. 8:00am – 5:00pm Eastern Time.

JLT Performance Lifetime Satisfaction Guarantee. We want you to be a JLT Performance customer for life! Your new JLT Performance product is warranted to be free from defects in materials and workmanship for the life of the *original retail purchaser*, subject to the limitations contained in our warranty found here. www.jlttruecoldair.com/warranty

We guarantee workmanship, tunability and even a pathway to discounted upgrades for substantially improved items.

Return Policy: All returns will be subject to a 10%-25% restocking fee. Air Filters will not be accepted for return unless they are in original plastic sealed bag. Please visit www.JLTtruecoldair.com for complete return policy.

Disclaimer: JLT Performance Inc. makes no warranties whatsoever, expressed or implied, oral or written to any purchasers, except the warranty above. JLT Performance Inc. hereby specifically excludes from any implied warranty of merchantability or implied warranty of incidental, secondary, or consequential damages of any kind whatsoever. All purchasers and users of products manufactured by JLT Performance Inc. agree to hold harmless and indemnify JLT Performance Inc. from any and all claims arising from their use. Failure to receive notice of any or the limitations contained in this disclaimer shall not serve to extend liability to JLT Performance Inc. for any claims arising out of use of its products.