

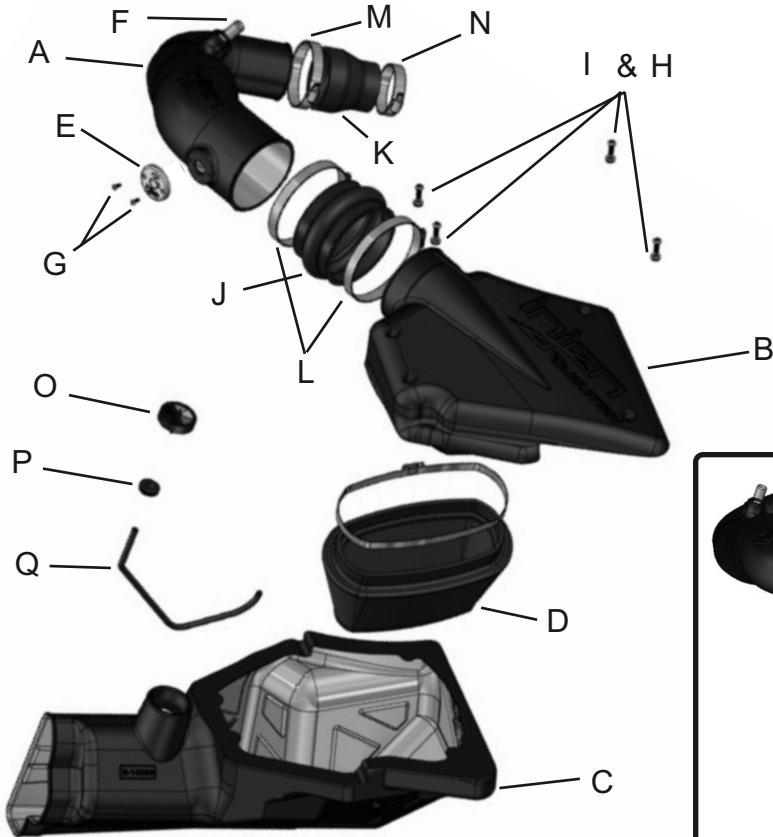

EXPLODED VIEW



Vehicle Application:

Make: **Ford**
 Model: **Mustang EcoBoost**
 Year: **2015**
 Engine: **2.3L 4 Cyl. Turbo**

Item	QTY.	P/N	Discription
A	1	#15083	Intake Tube
B	1	#15084	Intake Plenum
C	1	#15085	Air box
D	1	#1084	Dry Air filter
E	1	#15097	Air temp sensor adapter
F	1	#14063	Machined 5/8" Fitting
G	2	#6072	M4x16mm button head screw
H	4	#6096	M6x30mm bolt
I	4	#8047	Rubberized washer
J	1	#3200	4.5" Hump hose
K	1	#3108	2.3875"-3.00" Step Hose
L	2	#4014	#72 Clamps
M	1	#4004	#48 Clamp
N	1	#4008	#36 Clamp
O	1	#15040	Filter Minder
P	1	#8026	Grommet
Q	1	#3198	3mm VaCuum Line @ 15"

TOOLS REQUIRED

- 10mm Ratchet & Socket
- 8mm nut drive
- Allen key
- Needle nose
- Phillips Screwdriver
- Pliers

WARNING: FAILURE TO FOLLOW INSTALLATION INSTRUCTIONS AND NOT USING THE PROVIDED HARDWARE MAY DAMAGE THE INTAKE SYSTEM, ENGINE AND COMPONENTS!!!
***Do not attempt to install the intake system while the engine is hot.**
 Severe burn could result from touching hot engine components!

Report any defective or missing parts to the authorized Injen dealer you purchased this product from. Before installing any parts of this system, please read the instructions thoroughly. If you have any questions regarding installation, please contact your Injen Technology dealer. Installation DOES require some mechanical skills. A qualified mechanic is always recommended.

A Limited Lifetime Warranty to the original purchaser against defects in material and workmanship on all Injen intake systems excluding the filter element. Any and all warranty coverage is limited to the repair or replacement of the defective part only, at Injen Technology's discretion. The warranty does not cover incidental or consequential damages, nor does it cover the cost of installation or removal of the defective part or its replacement. Proof of purchase is required.

Instruction Manual P/N:EVO9200

NOTE: This intake kit may not work on vehicles with the following aftermarket modifications.

- Aftermarket Intercooler piping
- Aftermarket intercooler
- Turbo upgrade

Injen intake systems are street legal in most states unless the state is adopting to California Emissions standards. States that have adopted California emission standards include: Arizona, California, Connecticut, District of Columbia, Maine, Maryland, Massachusetts, New Jersey, New Mexico, New York, Oregon, Pennsylvania, Rhode Island, Vermont, and Washington. These states will require an California Air Resource Board Executive Order Number (CARB E.O.) for the legal use of an Injen intake system in your vehicle for use on public roads or highways. These vehicle will be considered "Legal in California only for racing vehicles competition use only, which may never be used upon a public street or highway. **Please keep your factory air box assembly for any future use.**

The SuperNano-Web filter media is a dry synthetic media that outperforms the competition. The media itself is a proprietary base blend of synthetics and cellulose. Cellulose fibers are larger than synthetic fibers, and have larger spaces between the fibers, causing contaminants to load in the depth of the media and plug the airflow path. This creates higher restriction levels and less capacity. The synthetic fibers in the SuperNano-Web media are submicron in diameter and have small interior fiber spaces, which result in more contaminants being captured on the surface of the media. This can help keep restriction levels low as the filter loads with dirt and containments



The image block contains the Injen Technology logo at the top left. Below it are two side-by-side microscopic images of filter media. The left image is labeled 'Existing media without Injen SuperNano-Web Technology' and shows a coarse, irregular fiber structure. The right image is labeled 'Superior Injen SuperNano-Web Technology' and shows a much finer, more uniform fiber structure. To the right of these images is a large, detailed image of the SuperNano-Web filter media, showing its characteristic pleated, woven structure. Below the large image is a spider icon and the text 'A New Generation of Filters Designed to perform and filter like no other'. At the bottom of the block is the text 'INJEN SuperNano-Web Technology'.

If you look at the picture to the left, you can see the Nano-fiber web on top of our base media. That web, or SuperNano-Web as we like to call it, helps trap smaller particles and protect your engine.

To Clean your filter:

Carefully remove the filter from the housing. Once removed, wipe down the housing using a clean shop towel, being careful not to knock any dirt and/or debris in the air inlet. Your filters can be cleaned by carefully vacuuming the filter media from the dirty side, or by holding the filter with one hand and carefully blowing the filter media at a 45-degree angle from the clean side using low-pressure shop air (15-20 lbs. psi).

****IT IS IMPORTANT TO NOT USE ANY CLEANERS ON THE SUPERNANO-WEB MEDIA OR APPLY ANY OIL!!!***

NOTE: DISCONNECT BATTERY BEFORE INSTALLATION!!!

Instruction Manual P/N:EVO9200



1. Stock intake system shown.



Remove 10mm bolt

2. Remove the 10mm bolt from the side of the stock OE air box.



3. Disconnect the air intake sensor harness and then twist the air temp sensor to remove it from the air box assembly.



4. Loosen the clamp on the factory air duct and then firmly lift the airbox from the engine bay.

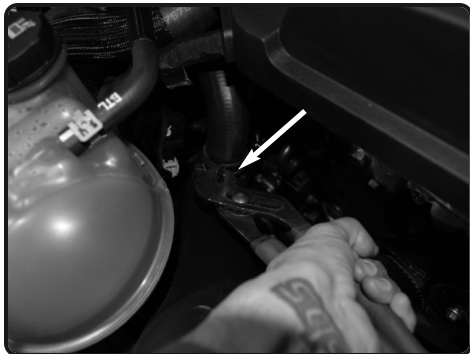

5. Use a channel lock wrench to loosen the tension clamp on the diverter valve return line to the factory air duct.



6. Slide the retaining clip on the breather line to detach the crank case breather line from the factory air duct



7. Loosen the clamp on the factory air duct on the turbocharger end and then remove the entire factory air duct from the engine bay.

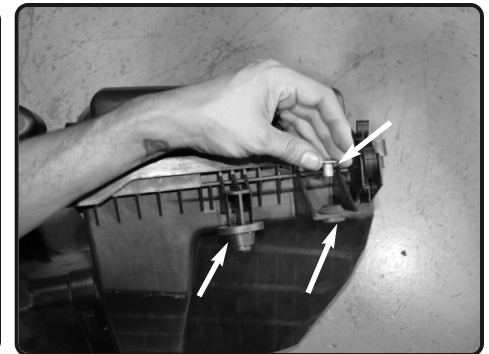

8. Remove the two grommets and spacer washer from the OE air box assembly

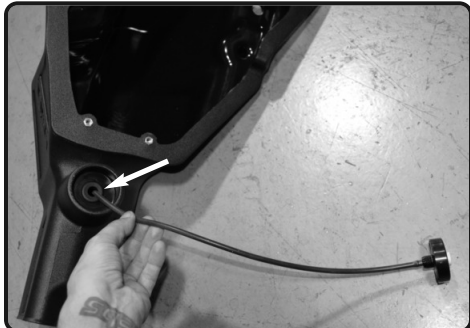

9. Install the grommet into the pod on the lower air box assembly. Then connect the 3mm vacuum line to the Filter Minder. Run the vacuum line through the grommet.



10. Install the smaller grommet and spacer washer from figure 8 into the 1/2" hole on the Injen lower air box assembly.



11. Install the larger grommet from figure 8 and install it into the original hole location on the fender well

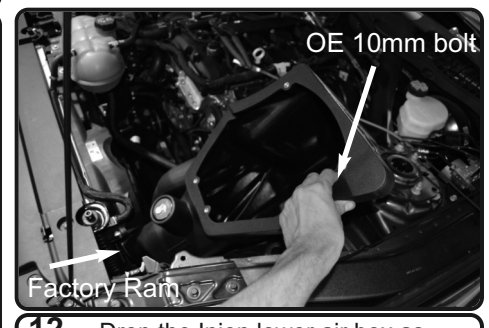

12. Drop the Injen lower air box assembly into the factory air box location. The front ram air should just slide into the Injen air box, Then secure the lower box to the chassis with the original 10mm bolt.



13. Place the filter onto the Injen plenum and then secure the clamp



14. Connect the 3mm vacuum line from the filter minder to the barbed fitting on top of the filter.



15. Place the Injen plenum onto the Injen lower air box assembly and use 4-M6X30 bolts to secure the plenum to the lower air box.

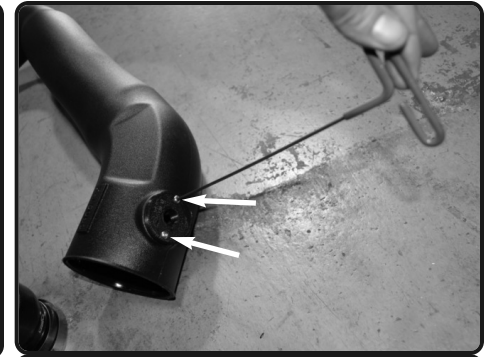

16. Place the machined air temp sensor adapter onto the tube and secure it with 2-M4X16 bolt.



17. Place the 4.50" hump hose and 2 #72 clamps onto the larger end of the Injen intake tube.



18. Place the 2.3875"-3.0" step hose and #48 and #36 clamps onto the smaller end of the Injen intake tube and only secure the clamp on the 3.0" side for now.

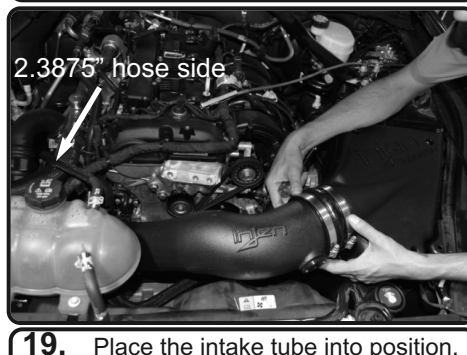

19. Place the intake tube into position. Slide the 2.3875" coupler onto the turbocharger and then slide the 4.5" hump hose over the plenum. Adjust the intake for best fitment and then secure the clamps

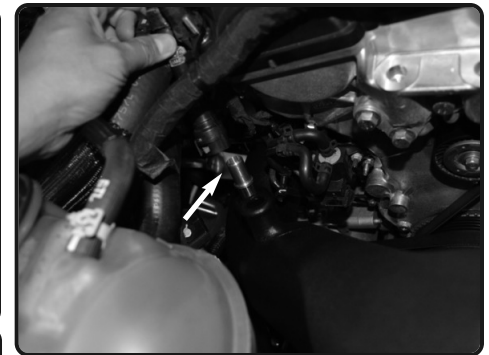

20. Connect the crank case fitting onto the Injen machined fitting on the intake tube. Make sure it clicks into place.



21. Re-connect the diverter valve return line to the port on the Injen intake tube use the factory tension clamp to secure it.



22. Screw in the Air temp sensor into the machined AIT sensor adapter.

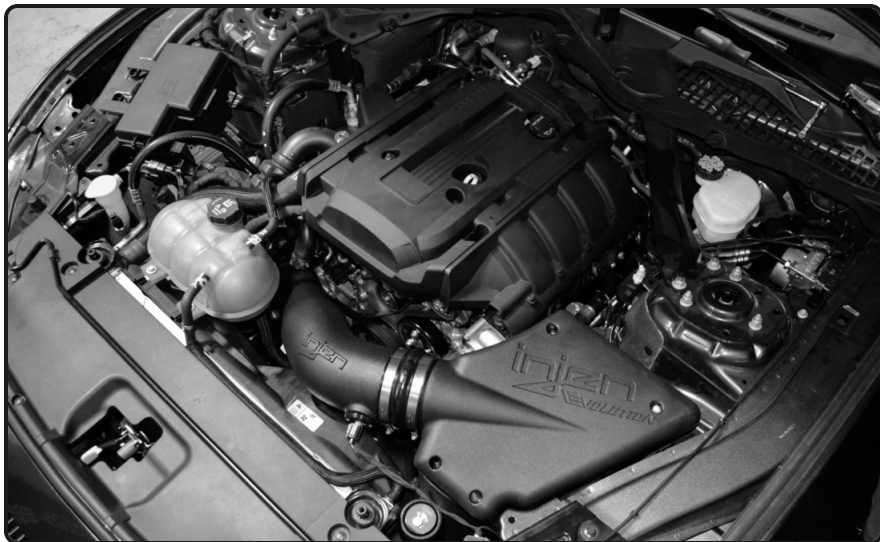

Congratulations! You have just completed the installation of this intake system. Periodically, check the alignment of the intake, normal wear and tear can cause nuts and bolts to come loose. **Note: Check clearance and adjust if needed! Failure to check the alignment and adjust the intake can cause damage that will void the warranty. Injen Technology is not responsible for any damages caused by/from improper installation.**

Test Drive:

1. With the transmission in neutral or park and the parking brake engaged, start the engine. Listen for air leaks or odd noises. If air leaks are detected, secure hoses and connections. For any odd noises, inspect entire system for cause and adjust intake as needed. The Injen intake will function identically to the factory system but will be louder and more powerful.
2. Perform a road test. Listen for odd noises or rattles and fix as necessary.
3. If there are no issues, continue to enjoy your added performance from the Injen performance Intake kit.
4. Injen Technology recommends you periodically check clearance and adjust if needed! Failure to check the alignment and adjust the intake can cause damage that will void the warranty. Injen Technology is not responsible for any damages caused by/from improper installation.

1. Upon completion of the installation, reconnect the negative battery terminal before you start the engine.
 2. Align the entire intake system for the best possible fit. Once the intake has been properly fitted continue to tighten all nuts, bolts and clamps.
 3. Periodically, recheck the alignment of the intake system and make sure there is proper clearance around and along the length of the intake. Failure to follow proper maintenance procedures may cause damage to the intake and will void the warranty.
 4. Start the engine and listen carefully for any odd noises, rattles and/or air leaks prior to taking it for a test drive. If any problems arise go back and check the vacuum lines, hoses and clamps that maybe causing leaks or rattles and correct the problem.
 5. Check the filter for excessive dirt build up. Clean or replace the filter with an original Injen filter (can be bought on-line at "injenonline.com").
- Congratulations! You have just completed the installation of the best intake system sold on the market. Enjoy the added power and performance of your new intake system.